

Walk-and-Talk Height Adjustable Stand

Quickstart Installation Guide

Required Tools



#2

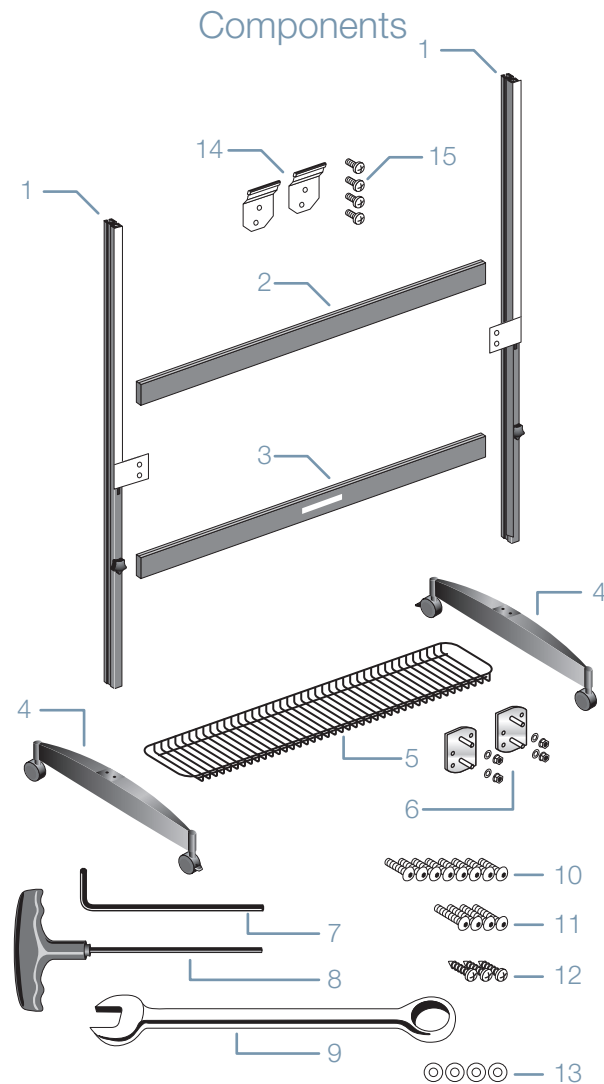

- 1 vertical column assembly
- 2 upper horizontal crossmember
- 3 lower horizontal crossmember
- 4 foot assembly with locking caster
- 5 wire basket
- 6 swivel plates, washers(4) and nuts(4)
- 7 Allen wrench (3/32")
- 8 T-handle Allen wrench (5/32")
- 9 3/8" combination wrench
- 10 eight 1/4-20 x 1 1/2" button head cap screws
- 11 four 1/4-20 x 3" button head cap screws
- 12 three #10 x 3/8" sheet metal screws
- 13 four 5/16" ID x 3/4" flat washers
- 14 two upper mounting brackets
- 15 four 10-32 x 5/16" pan head machine screws

STEP 1 Connect horizontal crossmembers, foot/roller assemblies, and upper brackets

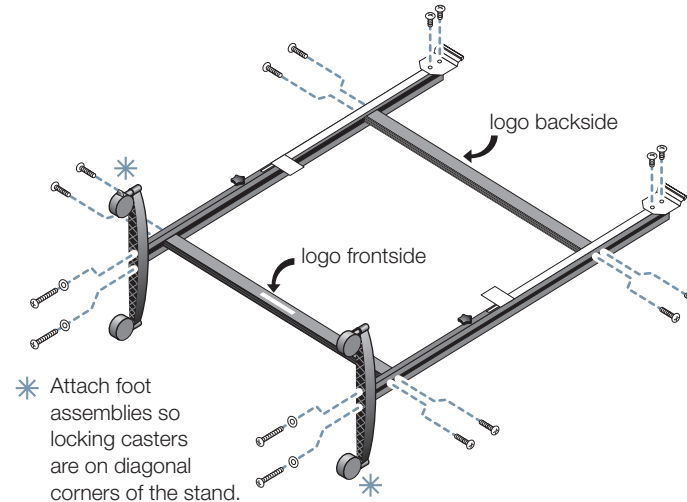

STEP 4 Install swivel plates and adjust to measurement **A**. (do not tighten yet)

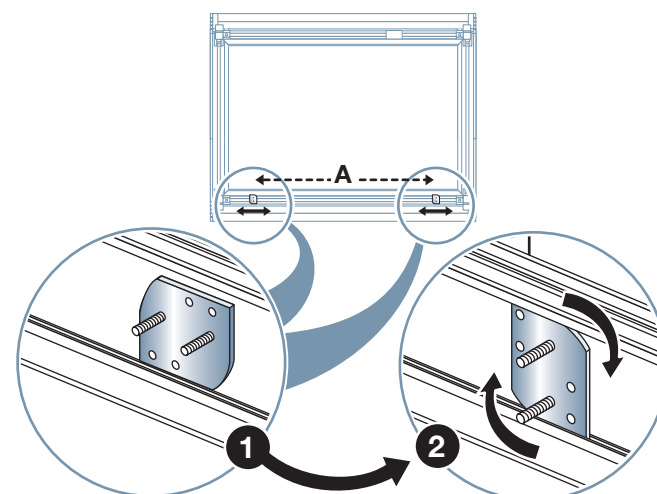

STEP 7 To adjust board height, loosen the knobs on the stand. Raise whiteboard to desired height by lifting in center and retighten knobs.

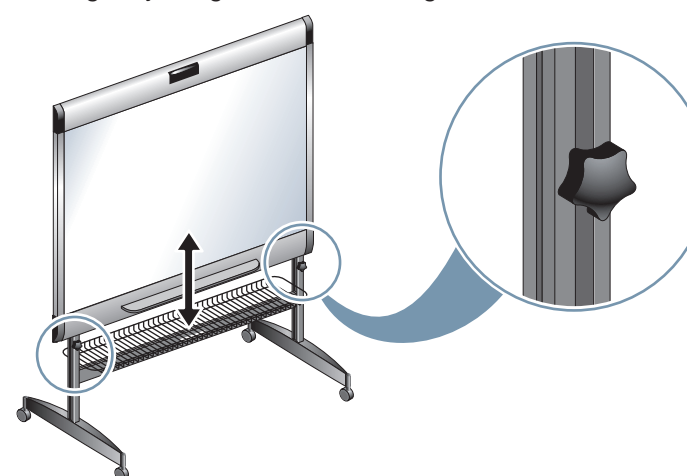

STEP 2 • Lock the two locking casters.
• Attach wire basket.

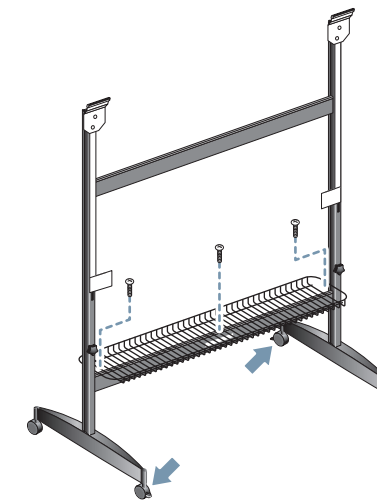

STEP 5 Hang Walk-and-Talk board from upper brackets so that measurement **B** is the same on both sides.

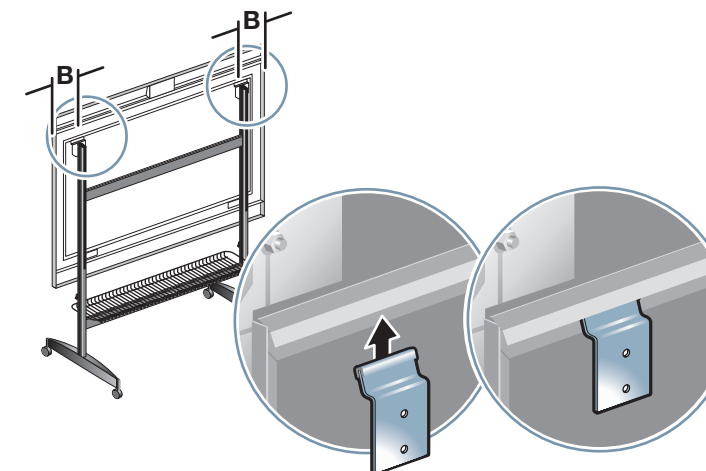

STEP 3 • Align brackets & tighten locking knobs
• Measure and record **A**.

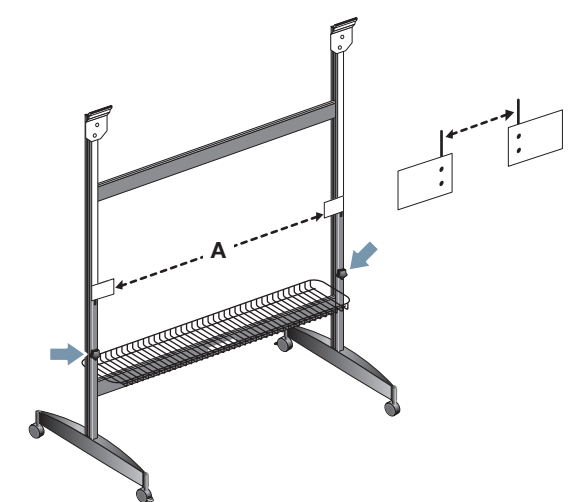

STEP 6 • Guide the swivel studs through the holes of the lower mounting brackets and fasten with washers and locking nuts provided.
• Tighten socket screws on swivel plates.
• Tighten lower brackets.

